

# UNIT PLAN

## FLAT D2 | 3B 2T

Available in Tower A

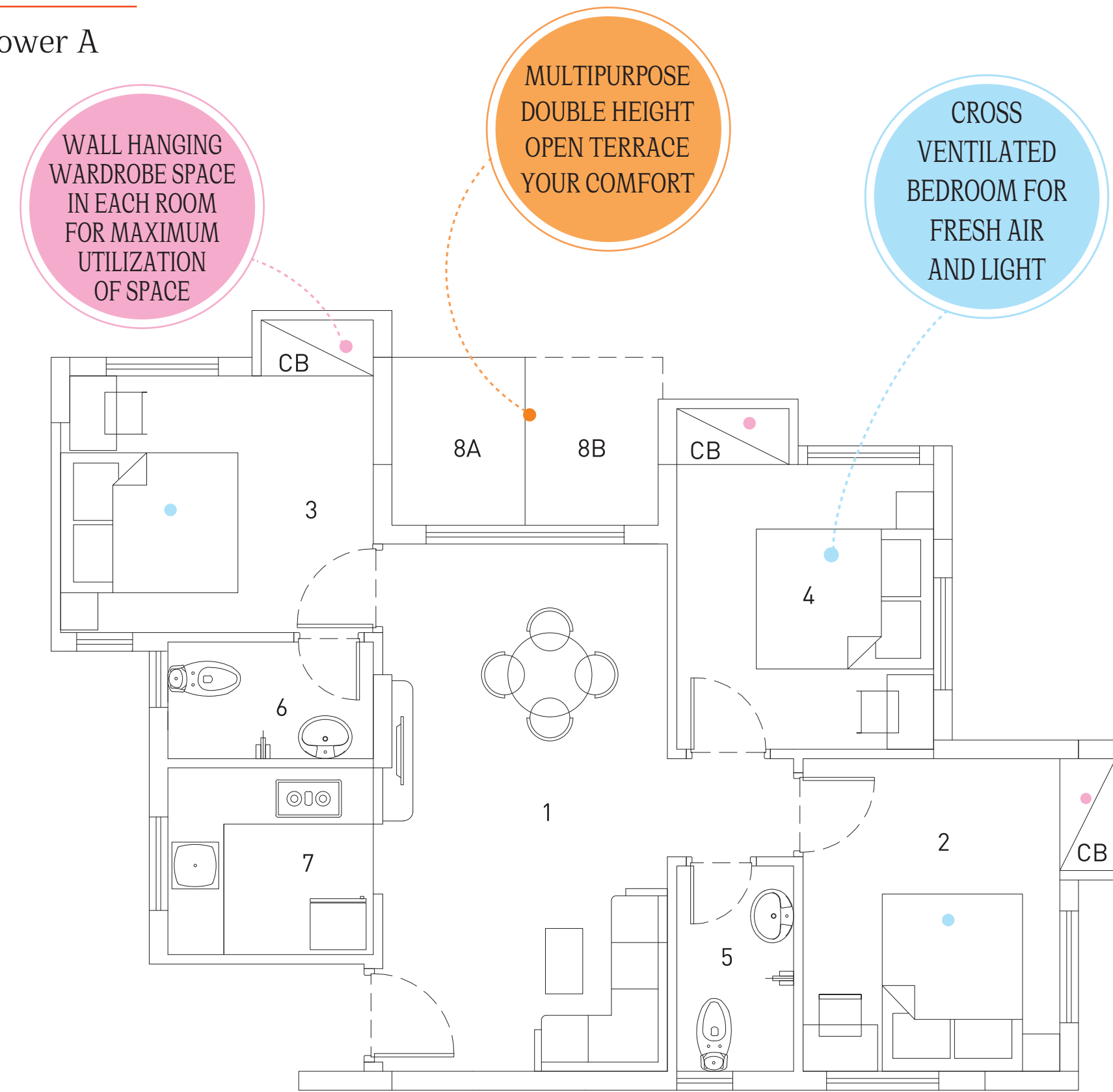

Carpet area	Built up area	Standard built up area
640	745	1050

① Living/Dining	10'0" x 18'6"
② Bedroom	11'0" x 11'0" (9'0" x 11'0" without CB)
③ Bedroom	11'0" x 11'0" (11'0" x 9'0" without CB)
④ Bedroom	9'0" x 12'0" (9'0" x 10'0" without CB)
⑤ Toilet	4'1" x 7'3"

⑥ Toilet	7'3" x 4'1"
⑦ Kitchen	7'3" x 6'7"
⑧A Balcony	4'8" x 5'11"
⑧B Balcony	4'8" x 5'11"